

HDMI Wall plate Extender

User manual

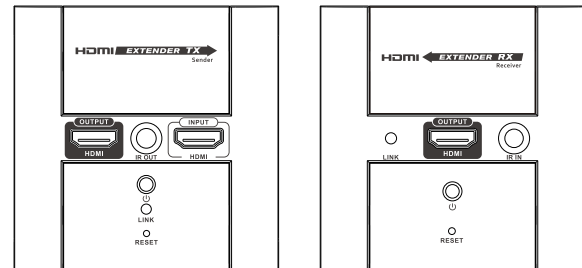

• Important Safety Notice

Please read below safety instructions carefully before installation and operation:

1. Do not expose this unit to rain, moisture and liquid.
2. Do not put any stuff on it.
3. Do not expose power lines on the unit surface to avoid the danger of electric shock.
4. Do not plug the device and connect cables when the device with power on to avoid cables damage.
5. Shut off power and make sure environment is safe before installation.

1. Introduction

HDMI wall plate extender is a wall plug type extender. It is made up of a sender and a receiver separately fixed on wall and can transmit up to 50 meters via single cat6 cable. IR is supported to allow controlling source device at the end of display.

2. Features

1. It is made up of a sender panel and a receiver panel. Plug and play.
2. Support AC 110-240V power input.
3. Use Cat6/6A/7 for long distance transmission.
4. Transmit 50 meters via cat6 cable 1080p 60Hz.
5. Auto adjustment for different network cable length.
6. Zero signal loss and pure hardware design.
7. Support IR remote control.
8. Attractive wall plate design.

3. Package contents

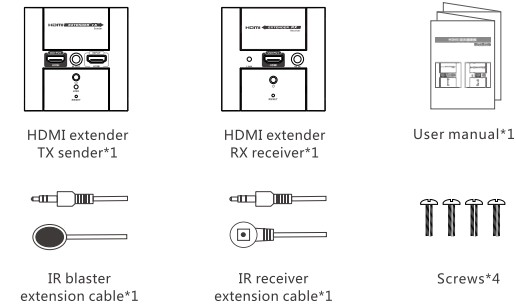

4. Installation Requirement

- 1). HDMI source device (DVD, PS3, Set top box, PC etc).
- 2). HDMI display device like SDTV, HDTV, and projector with HDMI port.
- 3). UTP/STP cat6/6A/7 cable, follow standard IEEE-568B

1-Orange/white	2-Orange	3-Green/white
4-Blue	5-Blue/white	6-Green
7-Brown/white	8-Brown	
- 4). Bottom case: standard type 86 case.

5. Panel description

- 5.1 HDMI Extender TX sender

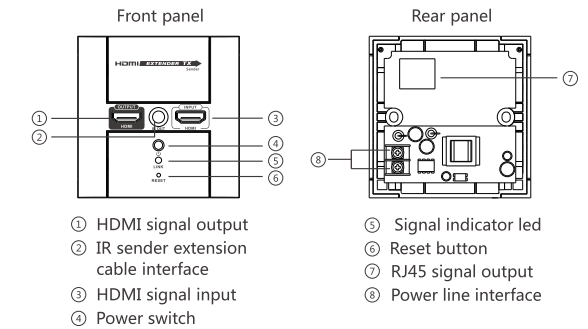

Note: signal indicator led. It lights on all the time with HDMI signal input, flashes with no signal input.

5.2 HDMI extender RX receiver

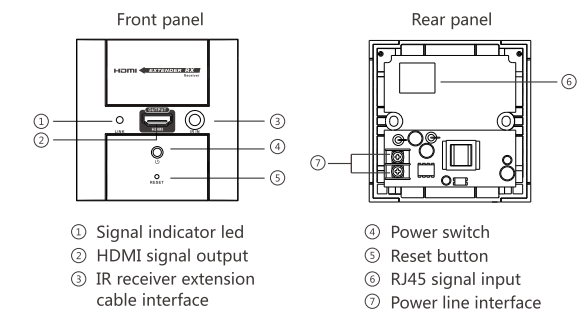

Note: signal indicator led. It lights on all the time with HDMI signal transmission, flashes with no signal transmission.

6. Installation procedure

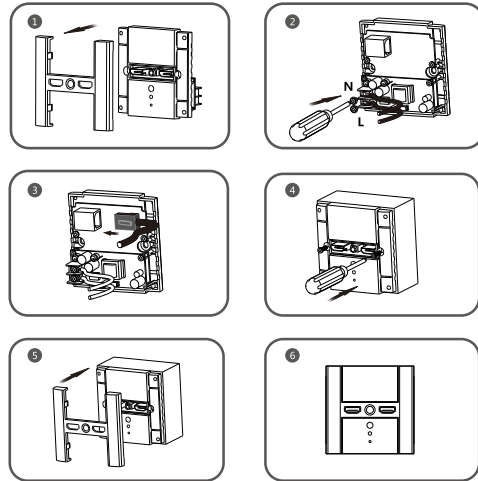

Note: please shut off power before installation

- 1 Open the extender wall plate cover.
- 2 Connect power line: use screw driver to unscrew and connect power line according to the mark on the base. "L" is live line and "N" is neutral line.
- 3 Connect network cable: make network crystal head as per the standard IEEE-568B (please refer to 4.3). Connect crystal head to receiver RJ45 interface.
- 4 Install the accessory screws to the corresponding positions to fix the extender wall plate to the base.
- 5 Fasten the cover to the extender wall plate.
- 6 Installation is done.

7. Connection

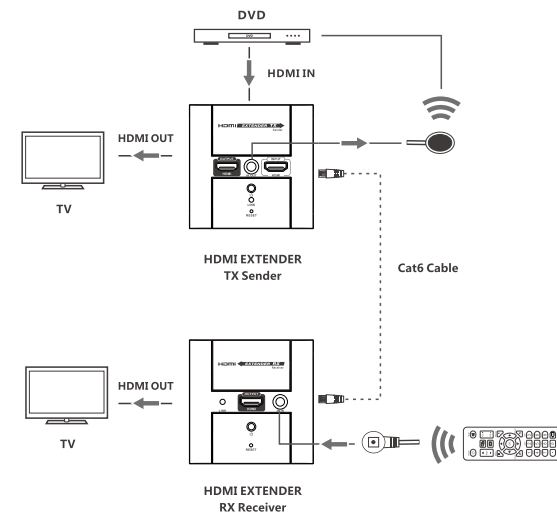

8. FAQ

Q: No image output or audio and video display is not normal?

A: 1) Press RX "RESET" button to reset the device.
2) Try shorter network cable and reconnect.

Q: RX "LINK" led is flashing all the time?

A: 1) Make sure network cable connection follows the standard of IEEE-568B.
2) Check whether TX has HDMI signal input.
3) Reset TX&RX and reconnect.

Q: RX "LINK" led lights on all the time but no image output?

A: 1) Press RX "RESET" button to reset the device.
2) Make sure HDMI cable is well connected with TV.
3) Plug out/in network cable or repower RX.

9. Specification

Item	Specification
HDMI signal	Compatible with HDCP
Support resolutions	480i@60Hz, 480p@60Hz, 576i@50Hz, 576p@50Hz, 720p@50/60Hz, 1080i@50/60Hz, 1080p@50/60Hz
Network cable	low resistance and consumption oxygen-free copper core (Cat6/6A/7)
Transmit distance	Cat6: 60m at 1080p 60Hz
IR remote control	Support 20~60kHz wide frequency IR remote control
Working temperature	0°C ~ 60°C
Power supply	AC 110-240V
Power consumption	TX: 2W RX<2W
Panel material	PC+ABS fireproof material
Product dimension	86(W) x 86(D) x 37(H) mm *2pcs
Weight	TX:93g RX: 90g
Color	White

Disclaimer

The product name and brand name may be registered trademark of related manufacturers. TM and ® may be omitted on the user manual. The pictures on the user manual are just for reference, and there may be some slight difference with the real products. We reserve the rights to make changes without further notice to a product or system described herein to improve reliability, function or design.